

**Cemetery Reserve/Burial Form**

**Decedent**

*Cortin*

Last Name

*Kaed Lamar*

First & Middle Name

Reservation \_\_\_\_\_

Burial  \_\_\_\_\_

Maiden/Alternate Last Name: \_\_\_\_\_ Nickname: \_\_\_\_\_

Date of Birth: *1/10/1928* Date of Death: *9/30/19* Date of Burial: *10/13/19*

Time of Mass: *12:00 pm* Time of Burial: *2:30 pm*

**REPRESENTATIVE / RESPONSIBLE PARTY FOR PAYMENT**

Representative: *Terri Cortin* Relation to Decedent: *Daughter*

Address: *5826 E Lee St, Apt. 3, Tucson, AZ 85711*

Cell Phone: *520-465-3211* Home Phone: \_\_\_\_\_

Email address: \_\_\_\_\_

<p>Plot Previously Reserved and Paid For \$000.00</p> <table border="0"> <tr> <td></td> <td align="center"><b>Resident</b></td> <td align="center"><b>Non-Resident</b></td> </tr> <tr> <td>Full Size Plot Purchase</td> <td align="center">\$500.00</td> <td align="center">\$600.00</td> </tr> <tr> <td>Single Cremain Plot</td> <td align="center">\$250.00</td> <td align="center">\$300.00</td> </tr> <tr> <td>8 Cre mains - Full Size Plot</td> <td></td> <td></td> </tr> </table> <p align="center"><b><u>SERVICES</u></b></p> <p>Open &amp; Close: Full Size (Machine) \$300.00</p> <p>Open &amp; Close: Full Size (Hand Dug) \$600.00</p> <p>Open &amp; Close: Cre mains \$300.00</p> <p>Open &amp; Close: Baby Plot (Machine) \$150.00</p> <p>Open &amp; Close: Baby Plot (Hand Dug) \$300.00</p> <p>Open Only: Full Size (Machine) \$150.00</p> <p><input checked="" type="checkbox"/> Open Only: Cre mains \$150.00</p> <p align="center"><b><u>OTHER</u></b></p> <p>Weekend or Holiday Burial \$100.00</p> <p><input checked="" type="checkbox"/> Maintenance Fee \$100.00</p> <p>Less than 2 days notice (\$100/day x ___ days) \$ .</p> <p align="right"><b>TOTAL: \$ <i>250.<sup>00</sup></i></b></p>		<b>Resident</b>	<b>Non-Resident</b>	Full Size Plot Purchase	\$500.00	\$600.00	Single Cremain Plot	\$250.00	\$300.00	8 Cre mains - Full Size Plot			<p>SPECIAL NOTES: _____</p> <p><i>Family will close cremain plot.</i></p> <p>_____</p> <p>_____</p> <p>_____</p> <p>_____</p> <p>Paid on: _____</p> <p align="center">Check / Cash / Other</p> <p>_____</p> <p>Check/Ref No.: _____</p> <p>_____</p> <p>_____</p>
	<b>Resident</b>	<b>Non-Resident</b>											
Full Size Plot Purchase	\$500.00	\$600.00											
Single Cremain Plot	\$250.00	\$300.00											
8 Cre mains - Full Size Plot													

**GRAVESITE**

Section Letter: P Row No. 309 Plot No. 16

Creains / Full Size Coffin / Plot with coffin & 4 creains / Plot with 8 creains

To be buried with: N/A Relation: \_\_\_\_\_

Is other person already buried? Yes /  No / To be buried at same time

Grave to be dug double deep: Yes /  No / Already is

**Additional Info/Special Instructions:**

---

---

---

---

---

---

# Plot Plan

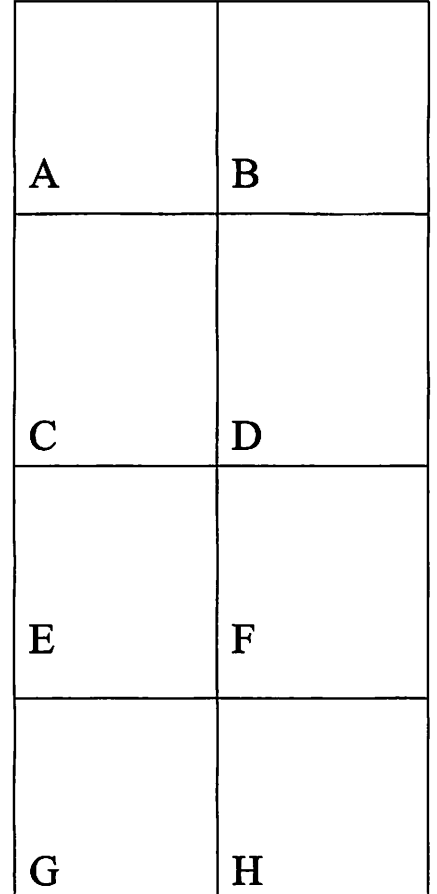
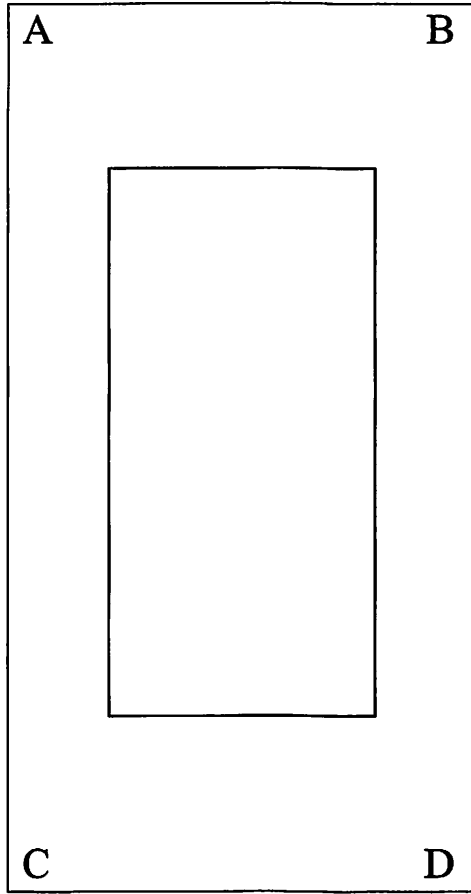
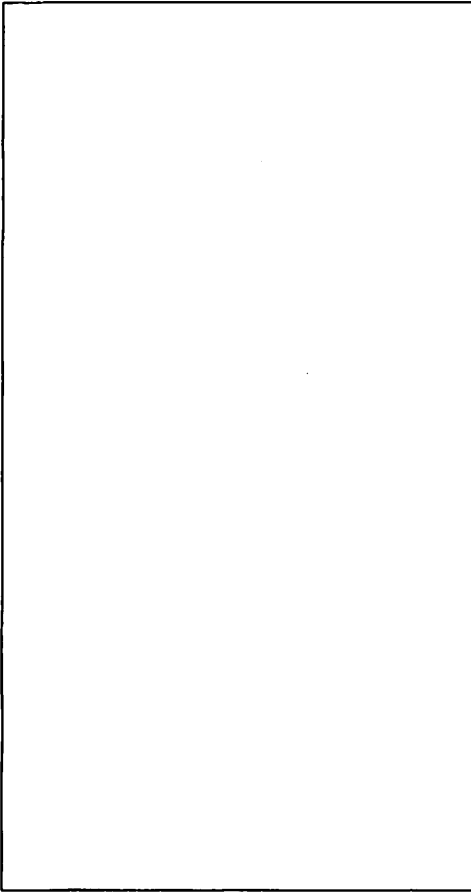

4x8 Casket Plot  
*single  
cremation plot*

4x8 Plot w/ casket &  
4 Cremains

8 Cremains Plot

Approved by Family Member:

Trevor Thornburg  
Print

*Trevor J*  
Sign

10.8.2019  
Date

Approved by Public Works

\_\_\_\_\_  
Print





\_\_\_\_\_  
Sign

\_\_\_\_\_  
Date

# EVERGREEN CEMETERY, BISBEE/LOWELL, AZ.

REVISED: 23 NOVEMBER 2015

## LEGEND:

-  CEMETERY ROADWAYS
-  GATE
-  FENCE
-  OLD PLOT MAP SECTIONS. (OPM)

ROWS: GO FROM WEST TO EAST  
PRESENTLY THERE ARE NO ROW MARKER SIGNS.  
FOR EASIER SEARCH OF ROW NUMBERS WE LISTED  
THE LAST NAME IN PLOT 1 IF AVAILABLE.

GRAVE PLOTS: GO FROM SOUTH TO NORTH  
EXCEPT FOR SECTIONS O, P, Q AND R WHICH  
GO FROM NORTH TO SOUTH

THERE CAN BE MORE THAN ONE PERSON IN A PLOT,  
DUE TO A DOUBLE DEEP PLOT OR CREMAINS.

FOR QUESTIONS, CORRECTIONS OR ADDITIONS  
PLEASE CONTACT:

DAWN BEEKS (520) 249-5595, [dawnbeeks@msn.com](mailto:dawnbeeks@msn.com)

WES PATIENCE (520) 432-4343

PETE GARCIA (520) 227-2605

PUBLIC WORKS (520) 432-6002

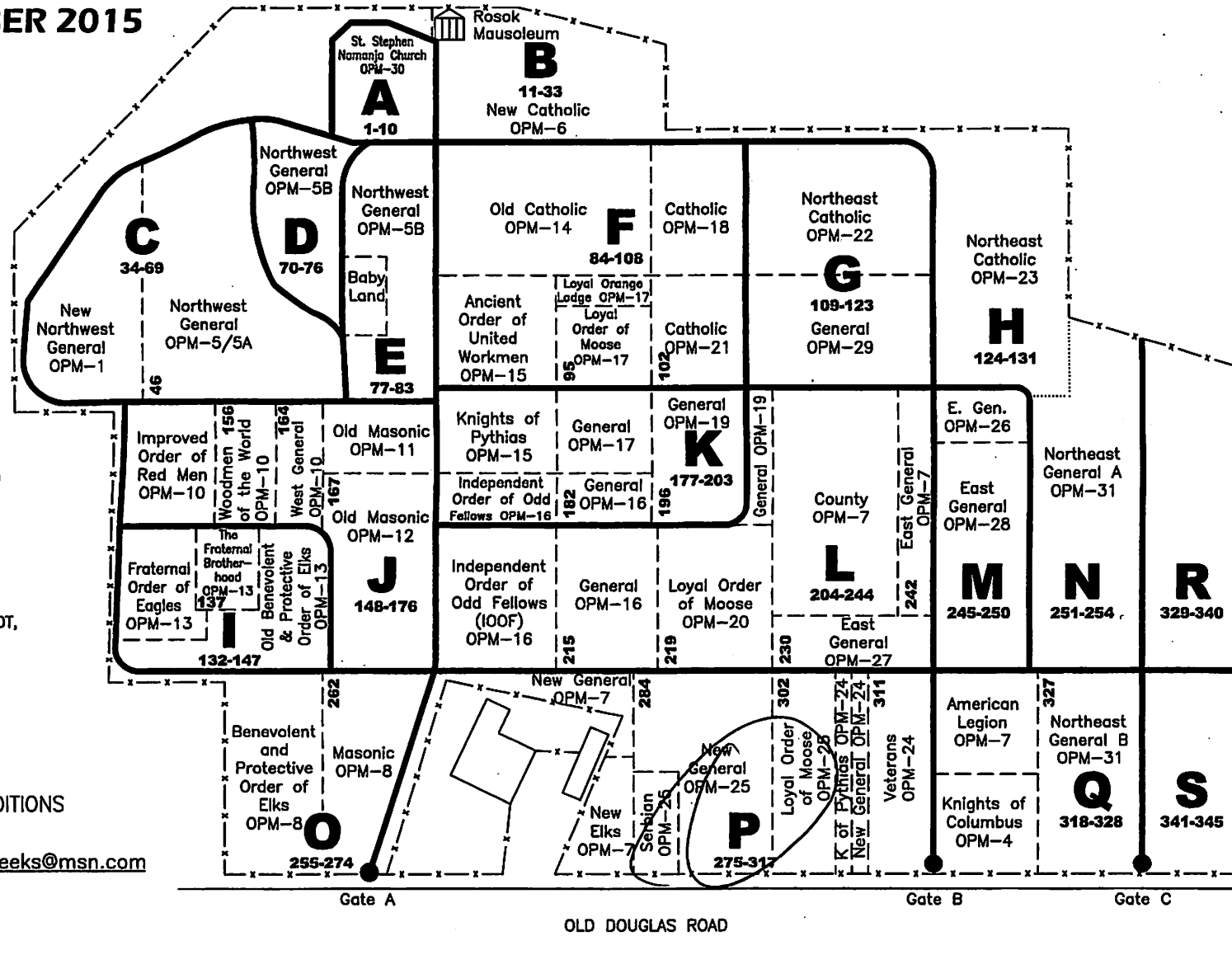

Gate A

OLD DOUGLAS ROAD

Gate B

Gate C

**SECTION P ROWS 275-317**

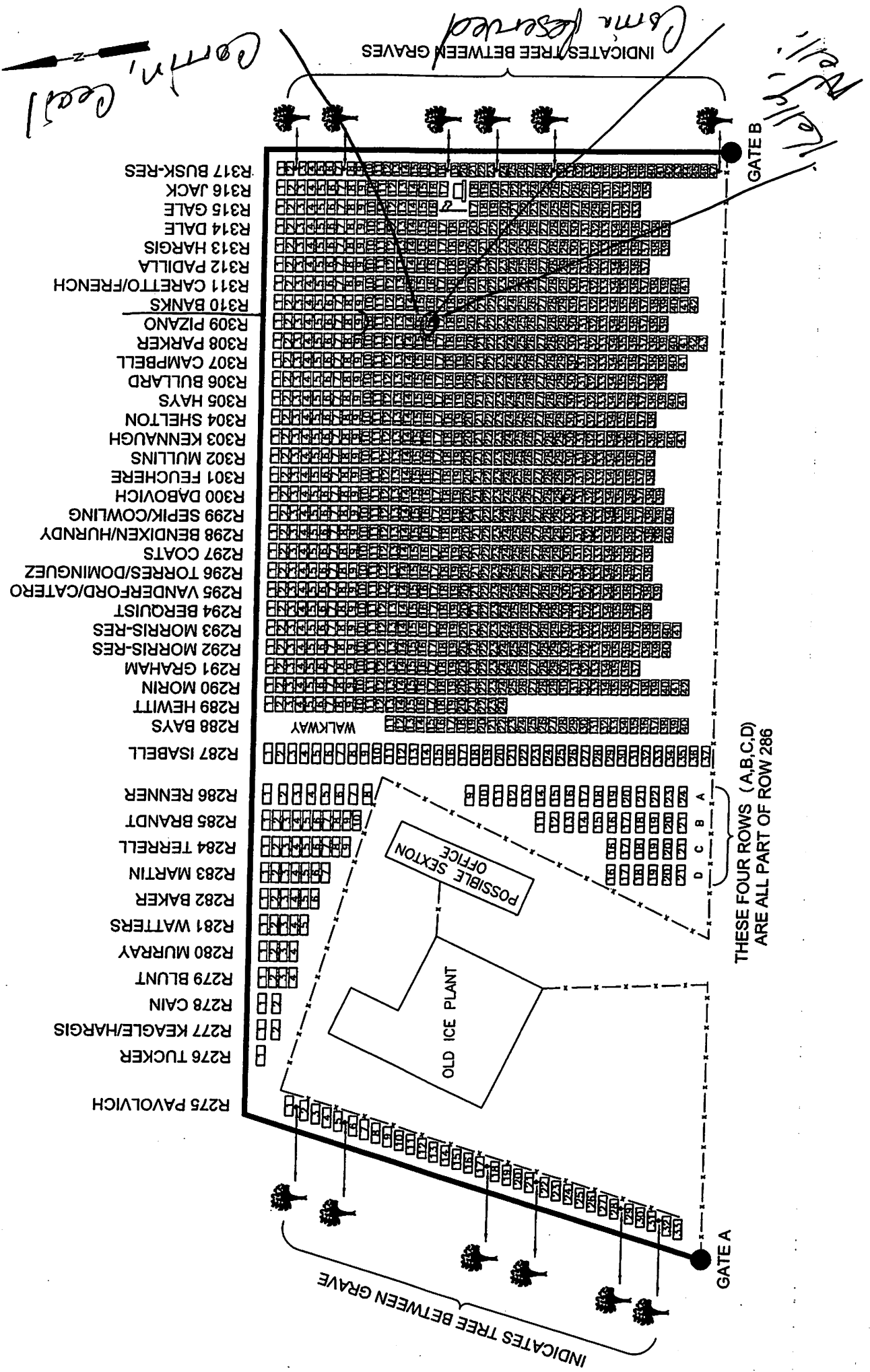

- R317 BUSK-RES
- R316 JACK
- R315 GALE
- R314 DALE
- R313 HARGIS
- R312 PADILLA
- R311 CARETTO/FRENCH
- R310 BANKS
- R309 PIZANO
- R308 PARKER
- R307 CAMPBELL
- R306 BULLARD
- R305 HAYS
- R304 SHELTON
- R303 KENNAUGH
- R302 MULLINS
- R301 FEUCHERE
- R300 DABOVICH
- R299 SEPIK/COWLING
- R298 BENDIXEN/HURNDY
- R297 COATS
- R296 TORRES/DOMINGUEZ
- R295 VANDERFORD/CATERO
- R294 BERQUIST
- R293 MORRIS-RES
- R292 MORRIS-RES
- R291 GRAHAM
- R290 MORIN
- R289 HEWITT
- R288 BAYS
- R287 ISABELL
- R286 RENNEN
- R285 BRANDT
- R284 TERRELL
- R283 MARTIN
- R282 BAKER
- R281 WATERS
- R280 MURRAY
- R279 BLUNT
- R278 CAIN
- R277 KEAGLE/HARGIS
- R276 TUCKER
- R275 PAVOLVICH

INDICATES TREE BETWEEN GRAVES

INDICATES TREE BETWEEN GRAVES

THESE FOUR ROWS (A,B,C,D) ARE ALL PART OF ROW 286

GATE B

GATE A

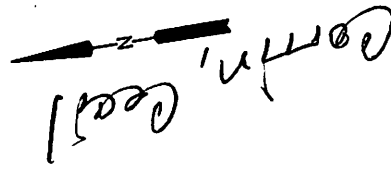

Cem reserved